

The TK Theory of Visual Proportions and the Person

Critical Design

Kim Lloveras i Montserrat 2025

The TK Theory of Visual Proportions.

Nothing is except for the Person. She introduces us to our TK Good Vision Cone, which is the only way to understand the world around us and provides us with the tools to act and enjoy it in the way we want.

Abstract

It is the always new and old PARADIGM: THE EYE OF THE PERSON.

For many years I have studied how we can understand our vision, since I have always believed that it was the best way to be an architect, urban planner and designer. In 1997 I proposed the existence of an area where we can see well, in which we feel inside.

I studied what the medieval builders had done ... if they had done something similar, and yes, they had used a circular Good Vision Cone to define all their spaces and give them meaning. Everything, measurements and vision, were made for the Person. I had shown that this Cone of Good Vision, although it had the same conception in plan, was not circular but elliptical.

Later I worked on its interior and discovered that the contours of its light-colours, with their multiple possibilities of grouping, were what really made us perceive the space that surrounds us. I studied everything in stillness, as if we were looking at a painting, and in motion.

That is why, if it is considered appropriate, I would like to exhibit La Portalada in the Congress, to make it known to Everyone.

Ascription to a Becoming

My proposal is The TK Theory of Visual Proportions. Ascribed to becoming Attuned as a form of meaning, ethics and aesthetics that we can incorporate into our daily professional practice: the knowledge of the TK Good Vision Cone will allow us to work worthily with the knowledge offered by the TK Theory. By becoming Embodied, using the criteria given by the TK Theory, we will be able to incorporate the values of all kinds and desires that we deem appropriate in the transition from matter to constructive beauty. Yes, the TK Theory of Visual Proportions will allow us to look for a particular solution, the most dignified that we know how to give, to solve these events.

In my opinion, it is that the main challenge we face today, and for many years, is ourselves: People. The TK Theory makes us know our Con of Good Vision TK that we enjoy. It is the only way to understand what the world around us is and provides us with the tools to act on it and enjoy it in the way we want.

We have evolved in many things, but NOT in visual, personal knowledge.

Contextual Information

10 images that describe the most important thing to insert TK Theory as Critical Design.

1 Early years of the Theory. From the beginning, in 1976, I was already thinking about the Person and his Cone of Good Vision.

2 Recognition of Jerzy Soltan (Harvard) and Roger Aujame.

3 Diversity of the visual studies carried out, which are exhibited on my website <https://www.espaistk.eu/>

4 The Eye of the Person is deepened as a Paradigm of what the design of space should be.

5 The projects and designs made throughout my professional life, both as an architect and urban planner, as a designer, are exhibited.

6 It deals with the most important part of my studies of visual proportions from the medieval period, The Sensitive Medieval Light.

7 It also deals with the medieval period and corresponds to the Exhibition of "Measuring the Medieval with Squares" sponsored by the College of Architects and exhibited in Les Corts, the Cathedral of Barcelona and Tarragona in 2017 and 2019.

8 It deals with what is intended to be done at the UIA Congress in Barcelona, which is to show La Portalada at the Congress in order to directly contrast its qualities.

9 From 1989 to 2006 I was the architect of the ICMAB and MATGAS buildings of the CSIC in Bellaterra.

10 In the intervention of the photovoltaic roof in 2006, called "the Leaf", I explain the importance of the TK Theory to influence the composition of spaces.

Image 1

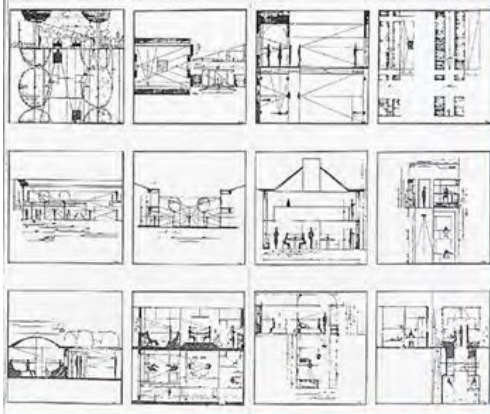

1976 – Selected by the Spanish state as one of the three representatives for the UNESCO world competition for young architects "The Habitat of Tomorrow", held in Paris.
<https://www.espaistk.eu/>
<https://www.espaistk.eu/biografia/>
<https://www.espaistk.eu/reconeizements/>

Drawing by Jerzy Soltan
<https://www.espaistk.eu/teories/teoria-tk/tk-1985-dibuix-sergi-soltan/>
 Theory TK 1985 Drawing by Jerzy Soltan
 It was not possible to understand the TK Cone of Good Vision, which appeared in the drawing made for Jerzy Soltan in 1985.
 It explains that the Person is on the edge of entering the space of light behind the dark space where She is.
 The TK Cone of Good Vision (CVB) appears for the first time.
 Jerzy Soltan, a disciple of Le Corbusier and Professor Emeritus at Harvard, understood this very well, and thanks to this drawing he offered me to go to Harvard as a Visiting Scholar in the 1988/1989 academic year.
 Unfortunately, it was not possible due to the opposition I suffered from within my own School.
 I will always be grateful to Jerzy Soltan.

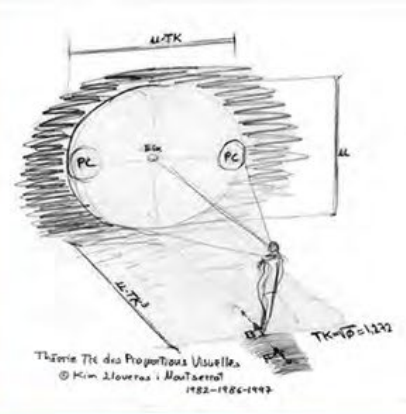

1982 – TK Theory of Proportions (in Spanish)
 The publication begins by studying the main historical proportions in the plane and seeks a maximum proportion on this surface.
 The constant TK is found as the value of maximum proportionality in the plane.
 The search for maximum proportionality continues, this time spatial, by introducing the Observer who looks at a plane that is defined in front of him when his view touches the ground. An intermediate plane is proposed in which the whole Person would be seen well, calling it the Plane of the Observed. With these conditions, TK emerges again as the constant of maximum spatial proportionality. Finally, a first image of the Person's body in this Plane of the Observed is proposed.



TK Theory 1986 The TK Vision Provided
 After the TK Theory of Proportions in 1982, in 1986 I published The Proportioned TK Vision. Among other things, I realized that our vision has a frontal zone of Good Vision limited by our physiological Blind Spots.
 Also that our own body is made with the same proportion, the TK Proportion, already defined in 1982.

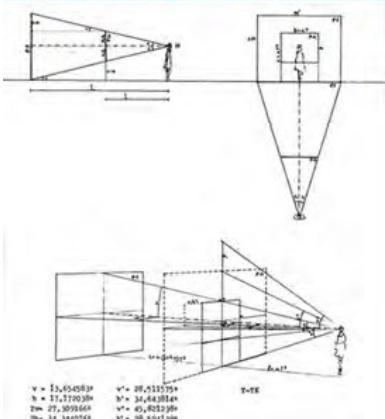

Search for Kim Lloveras
https://en.wikipedia.org/wiki/List_of_works_designed_with_the_golden_ratio
<https://dictionary.sensagent.com/Kim%20Lloveras/en-en/>
https://www.lhqusearch.com/visual_field

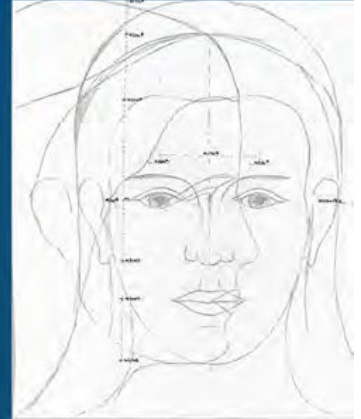
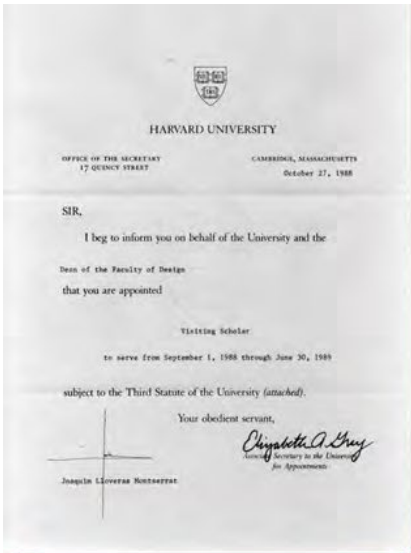

Image 2



Paris, 13 September 1989
 RADOC 890628
 Monsieur Kim Lloveras | Montserrat
 Architect
 Caponata 3, ent2a
 E-08034 BARCELONA

Dear Sir,

I have read your study with great interest
 On the TK theory of visual proportions.

It certainly paves the way for research on
 Spatial measurement systems provided. The reference
 Le Corbusier's Modulor is relevant since the principle is
 It is also based on human measurement and the golden ratio. But
 TK theory goes further with the three-dimensional concept of a
 based on the person's own vision. I
 I am sure that Le Corbusier would not have been insensitive to a
 this study.

We provide you, with your permission, with the French copy of your
 Study in the Foundation's library, available to
 Researchers.

With my thanks, please accept, Dear Lord,
 The security of my distinguished feelings.

Roger ALJAME
 Secretary General

THE LE CORBUSIER FOUNDATION RECOGNIZED AS BEING OF PUBLIC UTILITY
 8 SQUARE DU DOCTEUR-BLANCHE 76018 PARIS TEL. 42884183
 FAX-42883317

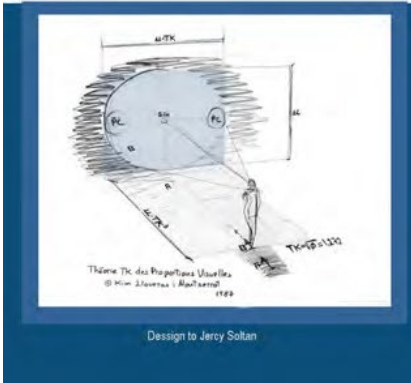

THE TK THEORY 1984/87 The Good Vision Cone and the drawing by Jerzy Soltan
 The jump from this rectangular background to the cone of vision that included it was almost immediate.

This is how the TK Good Vision Cone emerged
 The first use of the TK Good Vision Cone, and the first support, was in 1984
 when I was selected to represent Spain in the world competition "The Habitat of Tomorrow",
 convened by UNESCO in Paris, very far from what was asked ...
 was made in full agreement with the results of the Theory that began ...
 I only proposed how one could "think" the spaces to be enjoyed by People ...
 from the access roads to the habitat to the most intimate place for the Person ...
 passing through collective spaces ...
 I already took into account the importance of this privileged area of vision
 that is the Cone of Good Vision and its influence
 to help us define our spaces in a way that is close to us.

In 1987, Jerzy Soltan, professor emeritus at Harvard,
 asked me to synthesize the entire Theory in a single drawing ...
 If the Person is placed in A, even if He sees a hole of light, He "feels" inside A, of the darkness ...
 but if She reaches B, even if her body is inside A ...
 She "feels" to B ... in full Light A step forward had been taken ...
 had understood that the Cone of Good Vision is where we "feel"

Image 3

TK Theory 1997 TK Theory of Visual Proportions in Catalan.
Great summary of everything that has been studied in the TK Theory of Visual Proportions. It has multiple applications, from the knowledge of what the Visual Fields are. Direct colors and internal colors. Fusion. The Global Scheme of Visual Perception. TK Geometry. Where is the Center of Space. The Medieval Circular Cone of Good Vision and our real Elliptical Cone of Good Vision. To what extent can the TK Theory be applied, and many more things.

1997 TK Theory of Visual Proportions collected at UPCommons
<https://upcommons.upc.edu/handle/2117/1883?locale-attribute=en>

2012 Laws of Motion
<https://www.espaistk.eu/teories/teoria-tk/teoria-tk-v/>

2012 Pre-Form (Catalan – French – English – Spanish) (download)
<https://www.espaistk.eu/teories/teoria-tk/teoria-tk-vii/>

UPCommons Publicacions de l'Universitat Politècnica de Catalunya

1993 Citeaux La Lumière à Sânanque Medieval
<https://upcommons.upc.edu/handle/2117/1794>

1990 La Piedra de Mesura de Veruela
<https://upcommons.upc.edu/handle/2117/1793>

1997 Teoria TK de Proporcions Visuals
<https://upcommons.upc.edu/handle/2117/1883?locale-attribute=en>

2012 Mesura medieval: (video) L'Escalre NT, l'Escalre d'Hugues Libergier i l'Escalre de Poitiers (català, anglès, francès i castellà)
<https://upcommons.upc.edu/handle/2099.2/3124>

2015 La mesura del peu medieval a Santa Maria de Poblet : la mesura dels carres medievals = The measure of the medieval foot in Saint Mary of Poblet : the measure of medieval ashlar
<https://upcommons.upc.edu/handle/2117/80893>

TK
2015 Laws of positioning <https://upcommons.upc.edu/handle/2117/80893>

We are Not so different
https://ra.upc.edu/ca/recerca/projectes-recerca/copy_of_inici-no-som-pas-tan-diferents

Image 4

NEW PARADIGM: THE EYE OF THE PERSON

... and I learned that our eye is elliptical
... TK elliptical

yes... our eyes, the means by which we perceive the exterior light ...it himself is TK provided

Obviously, our vision is very complex, and, at a certain point, I understood that it was necessary to delve into the mechanisms of our vision to complete the Theory.

The TK Good Vision Cone
copyright Kim Lloveras i Montserrat 2025/26
<https://www.espaistk.eu/>

Teoria TK de Proporcions Visuals
Théorie TK des Proportions Visuelles
TK Theory of Visual Proportions
Teoría TK de Proporciones Visuales

1982 Drawing by Jerzy Soltan
Harvard Professor Emeritus
Disciple of Le Corbusier

Image 5

1993/94 Landscape Study in Arenys de Mar and Montserrat
Done

1993/96 Scientists' Residency in Ciutat Vella For the CSIC - Barcelona
Done

2000 My own Studio in Sarrià Barcelona
Done

2003 La Capella urbanization project Salàs de Pallars - Lleida
Not built

2003 TK Visual Experiences at the School of Architecture De La Salle - Barcelona

2004 Barcelona School of Architecture Bookshop Competition
Not awarded

2005 UNILAND Cement Museum in Garraf
Not built

2006 Housing in Torredembarra
Built

2008 Housing complex in Ibiça
Built

2008 Warehouse in Sant Miquel de la Vall Pallars Jussà
Built

2013 Cobert Puyero in Salàs de Pallars Renovation of the roof and interior
Built

2013 Publication, with my daughter Anna Maria, of the paths of Aiala Harria to Euskadi
Posted

2016 tkarb Physiotherapy Carrying out the design of the premises and all the cards and advertisements since 2000

2020 Sale of TK Theory Objects To the Jordi Capell Architects' Cooperative

2021 Christmas carol in the middle of the pandemic

<https://www.espaistk.eu/>

copyright Kim Lloveras i Montserrat 2025/26

Sample of all the professional activities in which the application of the TK Theory of Visual Proportions has been of fundamental importance to reach its final design.

... You can access my website for extensive information on everything that has been done and is being done...

Teoria TK de Proporcions Visuals
Théorie TK des Proportions Visuelles
TK Theory of Visual Proportions
Teoria TK de Proporciones Visuales

Image 6

Maps of Sensible Medieval Light and Sensible Cistercian Light

Here you can find almost 200 medieval ships that meet

The fact that the day of its dedication, the apsidal or western Light, or both at the same time,

They indicate on the axis of the ships its main Point: the place where the Person must be placed

So that, directing her gaze towards the apse, She visually penetrates the Light that comes out of it and invades Her.

Map of Sensible Medieval Light

Map of the Sensible Medieval Cistercian Light

<https://www.espaistk.eu/v-mapas-sensible-llum-medieval/>

In Catalan, French and English

In Catalan

NEW PARADISE FOR THE EYE OF THE PERSON

copyright Kim Lloveras i Montserrat 2025/26

Teoria TK de Proporcions Visuals
Théorie TK des Proportions Visuelles
TK Theory of Visual Proportions
Teoria TK de Proporciones Visuales

Image 7

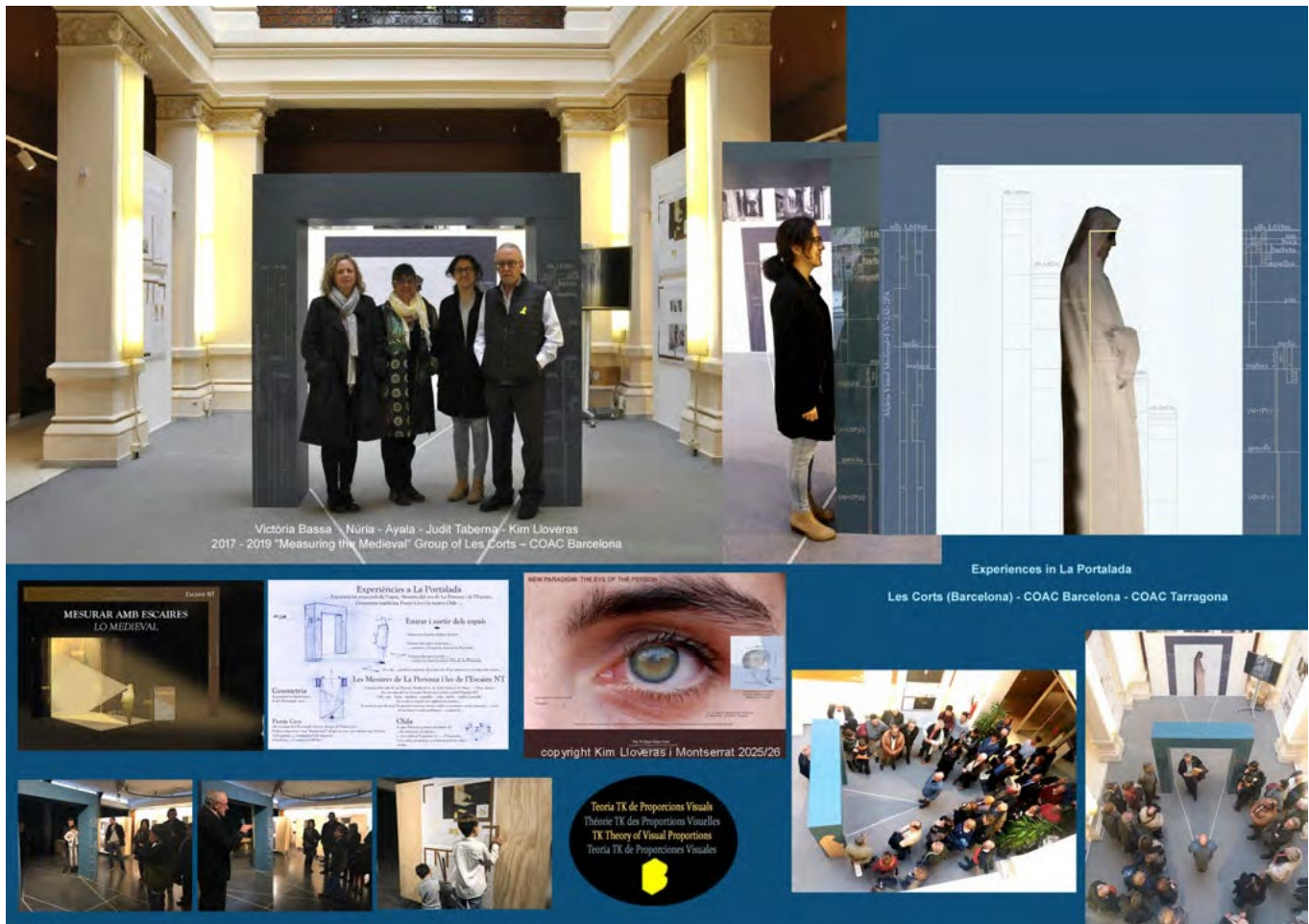

Image 8

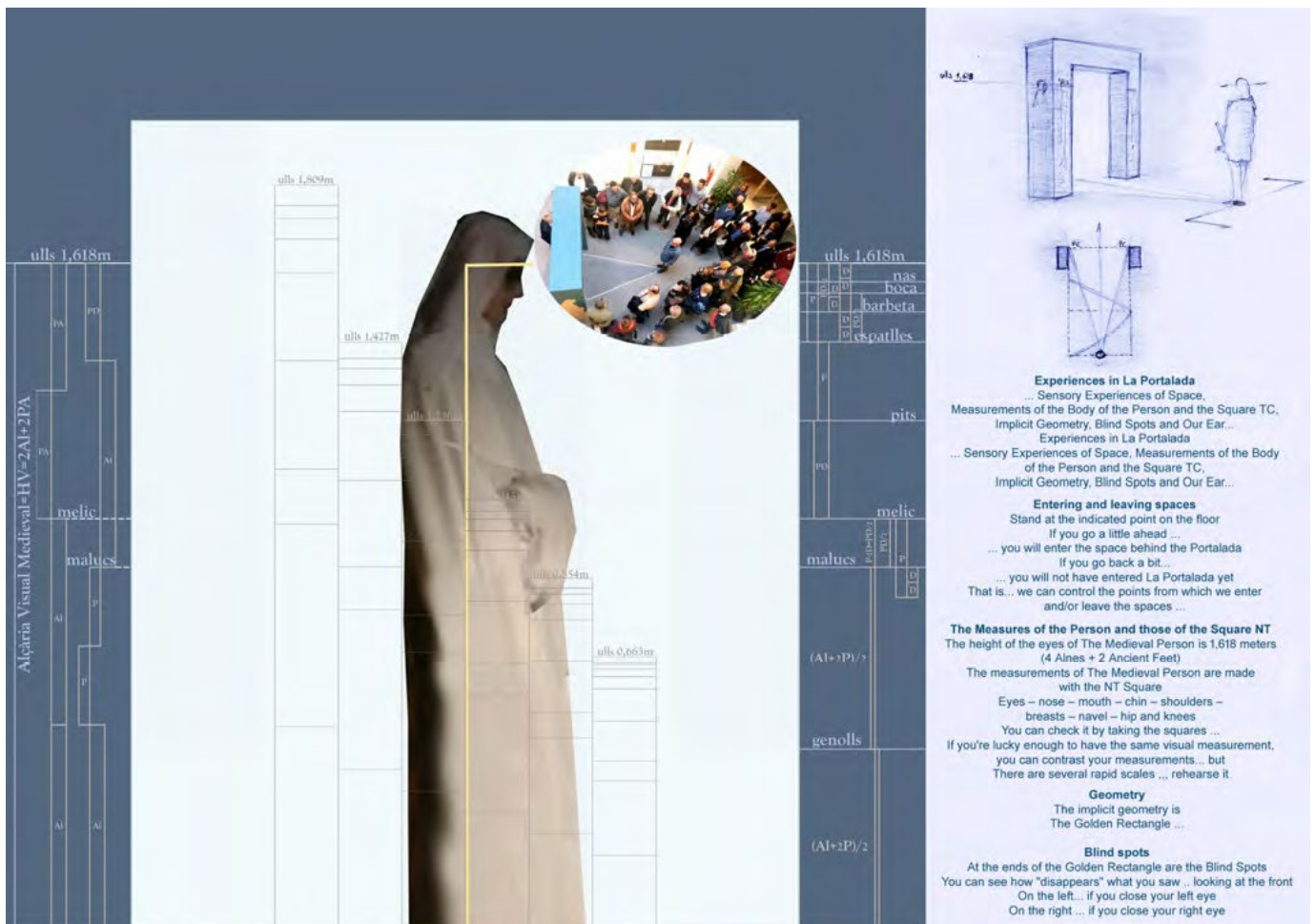

Image 9

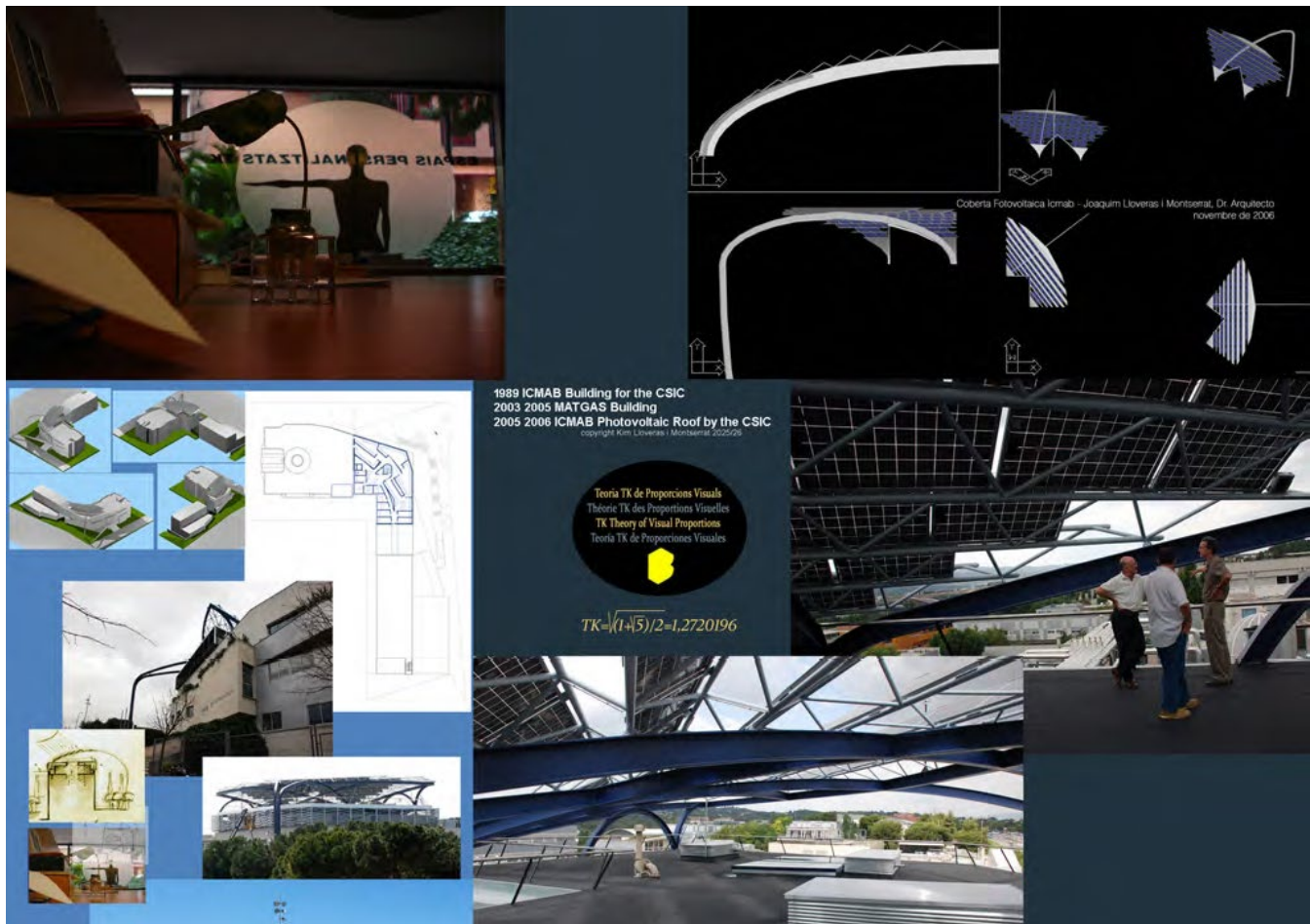

Image 10

